

FILED
GREENVILLE CO. S.C.

DEC 27 3 53 PM 1984

DONNIE S. TANKERSLEY
R.M.C.

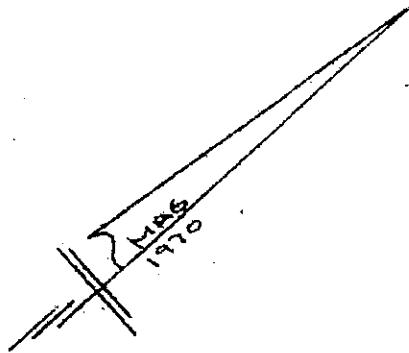

Note: Improvements on this lot are not in a flood hazard area.

VINEYARD LANE

CREEK

491-59-10E

92.59

148-00-50J
200.0

121.76
548-00-50E

30' DRAIN EASEMENT

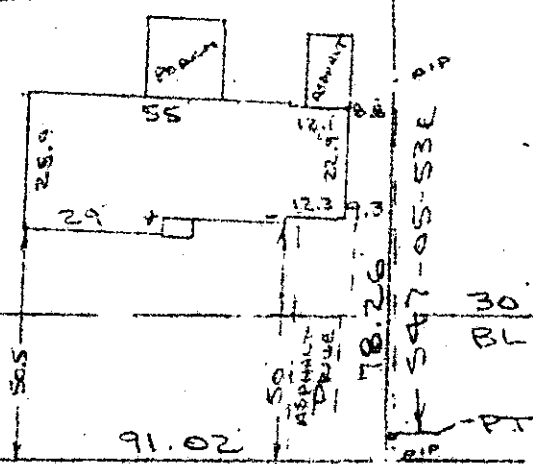

CROSSCREEK LANE
WATER & SEWER IN STR W

PROPERTY OF
MARCIA O. BARRON

NEAR GREENVILLE, S.C.
SCALE: 1" = 40' 19 DEC 1984

DEC 27 1984
19186

11-D-83

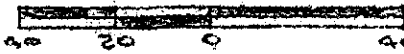

This is to certify that on the 19th day of December, 1984, I surveyed the property shown on this plat, being known as part of lot 44 on plat of MOUNTAINBROOKE and recorded in the RMC Office Greenville County, S. C., in Plat Book "4 - X" at Page 84 and also known as MOUNTAINBROOKE SEC. 1 - PART OF LOT 44 PROPERTY OF FRANZ SPAROVIC and recorded in Plat Book "6 - X" at Page 90; and that the property lines, walls and buildings are as shown hereon, and that the walls and buildings located on said lot do not encroach or project on adjacent street or property, and that no adjacent walls or buildings encroach or project on said premises, and no power lines cross this property except as shown hereon.

Recordable Plat

CAROLINA SURVEYING CO.
112 Manly St., Greenville, S.C.

ROBERT BRUCE
R. B. Bruce, RLS 1952

5010 -----1 DE27 84 027 3.0000